

12-1110

Jewish Home for the Aging

1885 Victory Blvd. Reseda, CA

FM-07-109

CREATED BY: HH

FrameMax, Inc.
13915 Danielson St
Suite 100
Poway, CA 92064
www.framemax.com



© FrameMax Inc.

CREATED: 11/05/2008

HEIGHT : 11'-7 3/8" POINTS: 7.35 Points.

SPACING : 5000"

1st STUD: 5000"

WEIGHTS :

FRAME : 855 lbs

SHEATHING: 543 lbs

TOTAL: 1398 lbs

APPROVED
By hhuynh at 9:10 am, Dec 04, 2008

DUE TO WALL BEING TO TALL FOR SHIPPING,
PLEASE SPLIT PANEL HERE

DUE TO WALL BEING TO TALL FOR SHIPPING,
PLEASE SPLIT PANEL HERE

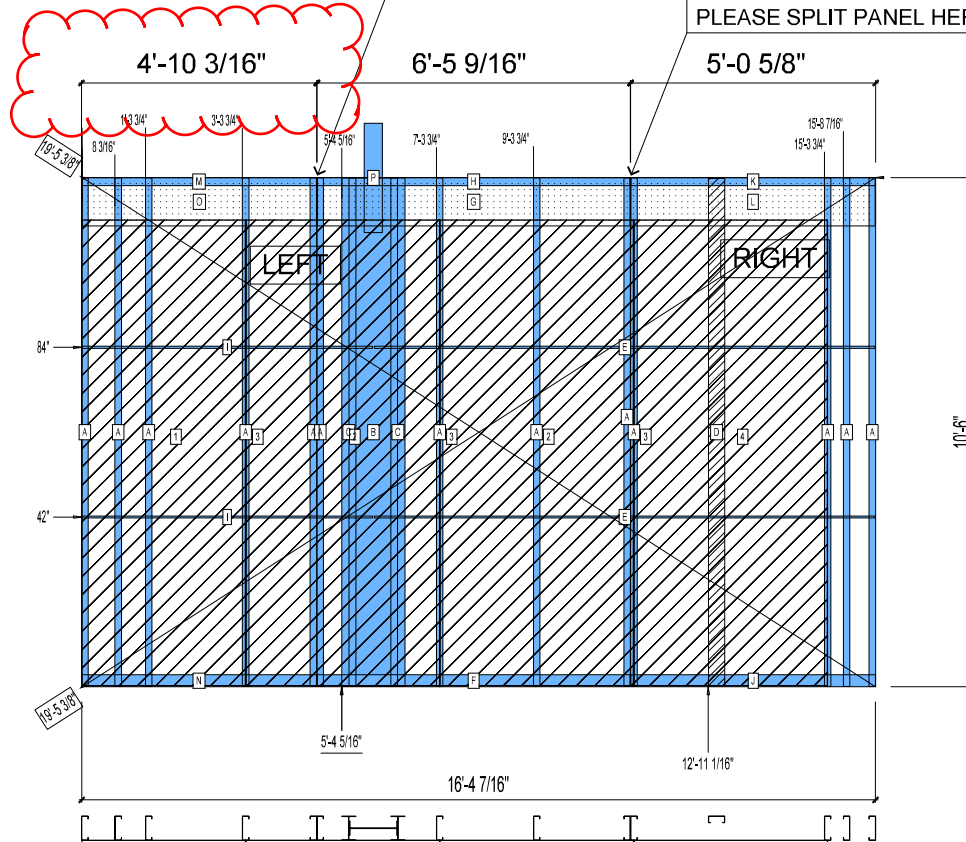

PIECES LIST

LABEL	QTY	SIZE	LENGTH	USE
A	13	600S162-68	10'-5 13/16"	STUD
B	1	1200i350p1420	10'-5 13/16"	PACO
C	2	600i350p968	10'-5 13/16"	PACO
D	1	400S162-33	10'-5 9/16"	BACKER-U
E	2	150U50-54	10'-3 15/16"	HORIZONTAL BRACING
F	1	600T300-68	6'-5 7/16"	BOTTOM TRACK
G	1	1200D-54	6'-5 7/16"	STRAP
H	1	600T200-68	6'-5 7/16"	TOP TRACK
I	2	150U50-54	5'-11 13/16"	HORIZONTAL BRACING
J	1	600T300-68	5'-0 1/2"	BOTTOM TRACK
K	1	600T200-68	5'-0 1/2"	TOP TRACK
L	1	1200D-54	5'-0 7/16"	STRAP
M	1	600T200-68	4'-10 1/16"	TOP TRACK
N	1	600T300-68	4'-10 1/16"	BOTTOM TRACK
O	1	1200D-54	4'-9 7/8"	STRAP
P	1	B	2'-3"	HOLDDOWN

SHEATHING

LABEL	QTY	CODE	THICK	SIZE	SCREWS
1	1	SB-DENSARMOR	5/8"	3'-4 1/2" X 9'-7 3/16"	2 - 12
2	2	SB-DENSARMOR	5/8"	4'-0" X 9'-7 3/16"	2 - 12
3	3	SB-DENSARMOR	5/8"	0.025 X 9'-7 3/16"	2 - 12
4	1	SB-DENSARMOR	5/8"	3'-11 15/16" X 9'-7 3/16"	2 - 12